

Digital Hydrometer

- High Precision
- Bright Backlit Display
- Large Digital Screen Display
- Low Battery Sound Alert

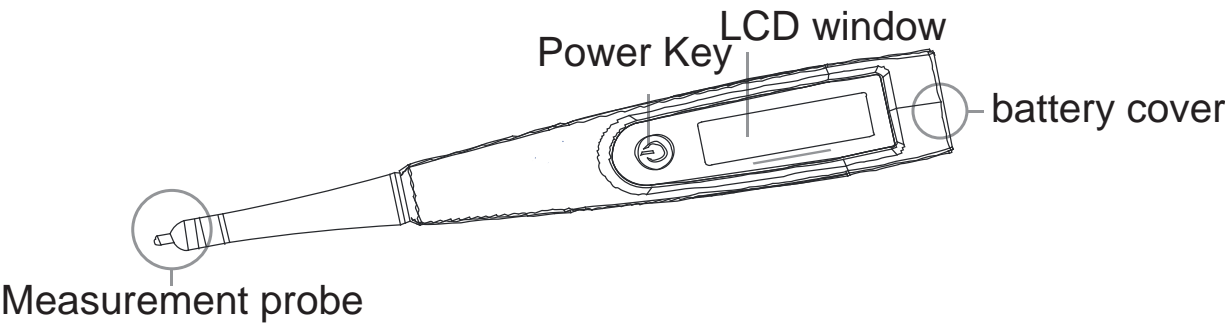

Product Specifications



LCD Status

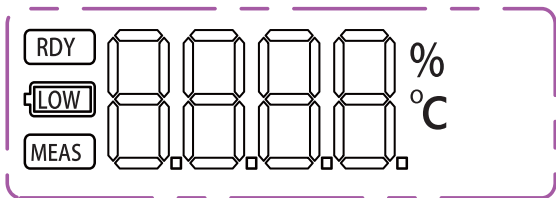

- RDY** Flashes when ready to begin measurements
- LOW** Flashes when battery is slow
- MEAS** Flashes when taking measurement

Testing method Electrical conductivity methods

Specifications

	S.G	PPT	Temperature
Range	1.000-1.041	0-50	1-40 ℃
Resolution	0.001	1	1℃
Accuracy	±0.001	±2	±1

Testing condition 1℃ ~ 50℃

Saving function Power off after 60 seconds

Temperature compensation A.T.C

Display area LCD(with backlight)

Low battery reminder icon flash

Power supply 1.5V × 2EA(AAA type battery

Waterproof Life waterproof

Instructions

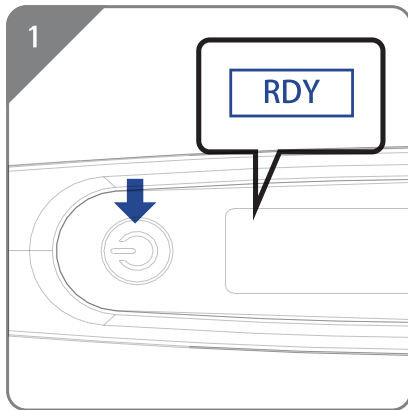

Press power key to start the device
(**RDY** Icon will be flash)

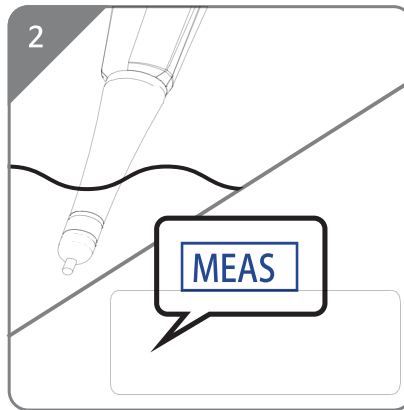

Place gravimeter measurement probe tip (as shown) in testing water
(**MEAS** icon will flash and the test begins)

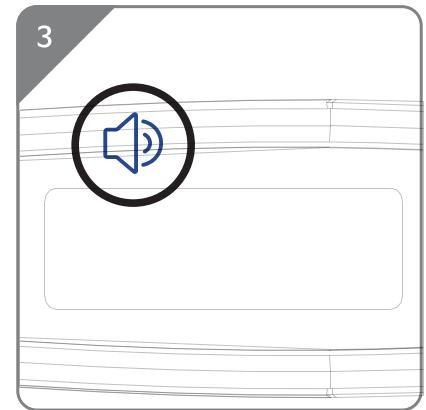

The buzzer will sound and the backlight will illuminate to display the result

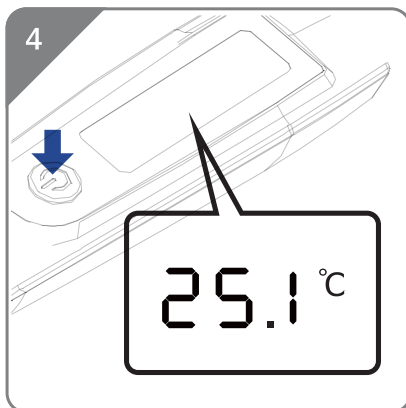

Press the power key to display the SG value (unit:PPT), Press key to display temperature value(unit: °C), press key more to power off

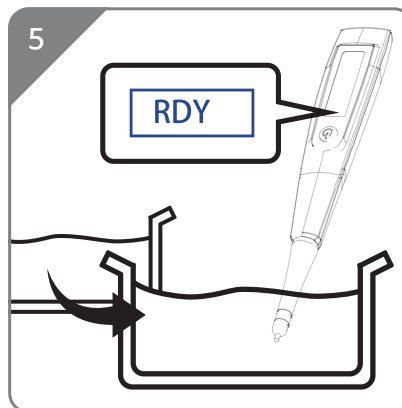

Clean the probe ready for its next usage, Place the probe in natural water and wait till the **RDY** icon appears on the display

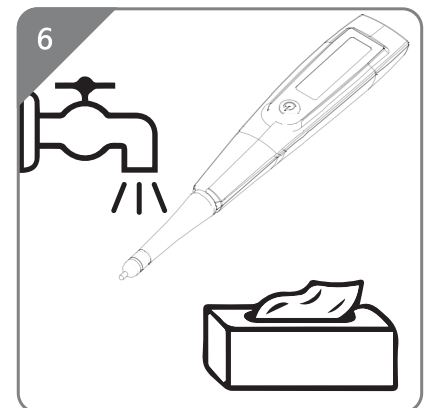

Use fresh water to clean the probe and use soft cloth to dry.Keep dry when stored

Measurement Precautions

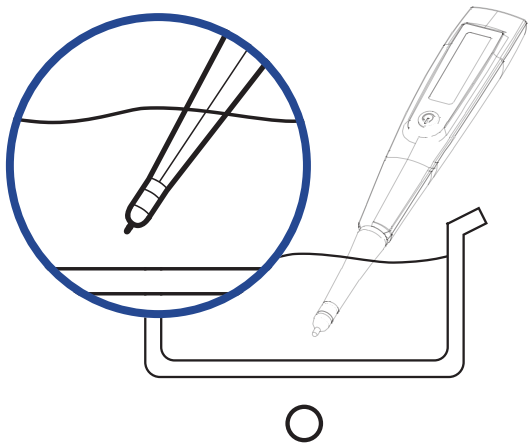

Keep the measurement sensor probe away from the bottom and the sides of the testing cup. Allow 1-2cm clearance around the probe

Do not touch any residue in the liquid

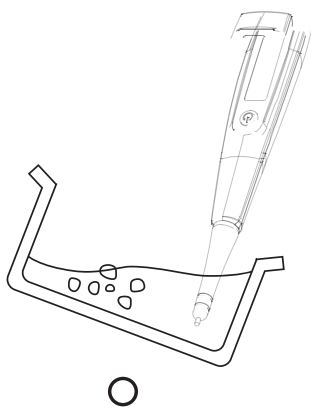

When there is not enough liquid lean the cup

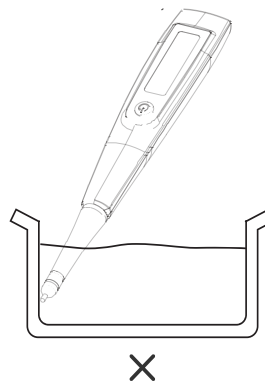

Do not touch the probe to the testing cup

◆ Please note

The metal part of the testing measurement probe must be completely in the test liquid. You should always check the accuracy of your meter against reference solution to verify its accuracy.

Storage Precautions

Do not use or store near heaters

Only use recommend battery listed under specifications. Replace both batter at same time

In order to prevent product failure ,do not dismantle the product

If the gravimeter is dropped or impact. there will be errors in testing

Scratches or deformation of the probe can lead to greater errors in testing

After usage, Clean test probe with water and soft cloth

When storing for a long time, Please remove the battery

Battery Replacement

◆ replacement time: icon flash

Although the Gravimeter had power there is no longer enough current to conduct a test accurately

tThe icon can also flash when the new battery does not work after insertion and need to be re-insertion

the new battery may also lead to natural discharge due to long circulation time, when  icon flash, replace the new battery at this time.

◆ replacement method

Turn the batter cover counter clock wise to "OPEN" and remove the batteries

Put in to 2 x AAA battery with the "+" direction facing outward

Refer to the figure below and turn the battery cover clockwise to "close"

To prevent damage to the gravimeter pay attention "+" "-" pole of battery

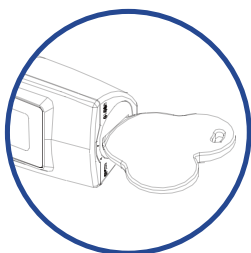

use key to open
the battery cover

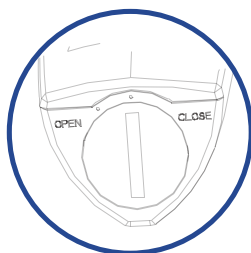

close

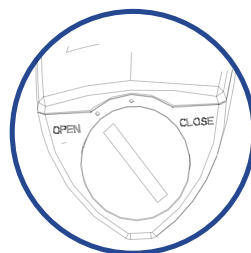

open

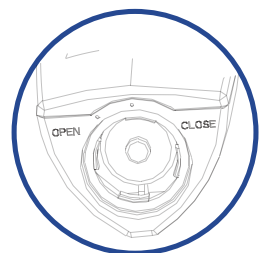

the status of open